

# Dell Solid State Drive

## Quick Start Guide

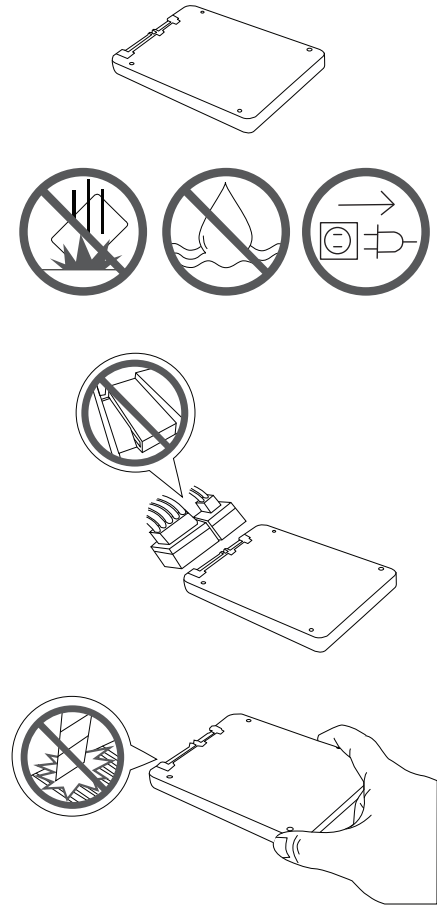

**NOTE:** For installation instructions for your Dell computer, see Service Manual at [Dell.com/support](http://Dell.com/support).

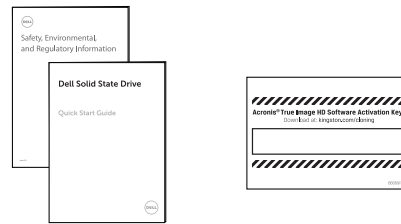
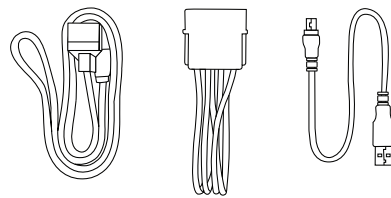
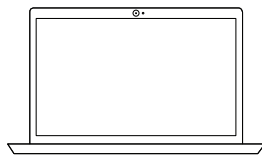

- 1 **NOTE:** If there is extra space in the Solid-State Drive (SSD) bay on your computer, peel off the tape on the adapter frame and adhere it to the SSD (optional).

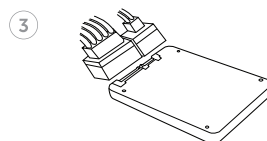
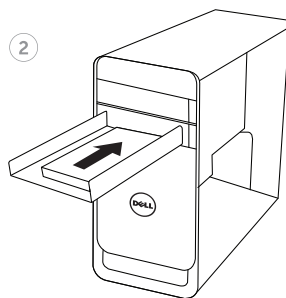
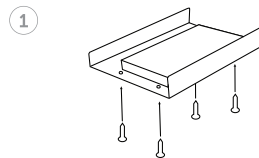
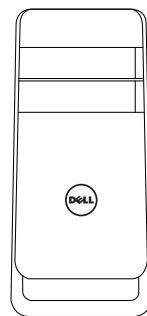
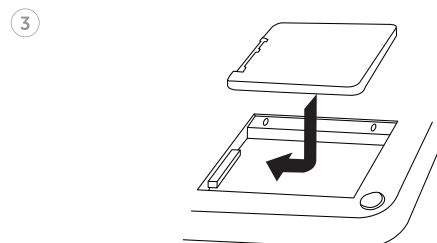
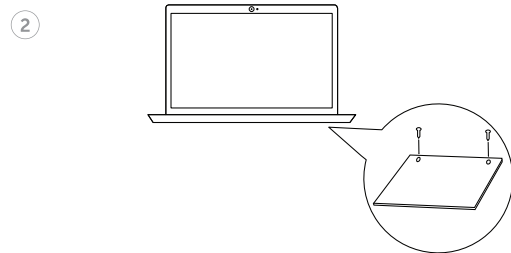
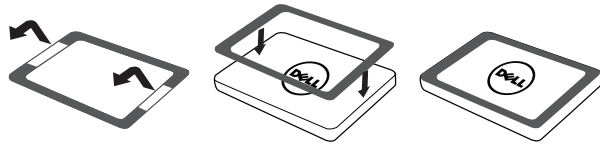

## Getting Started - Cloning

**NOTE:** For instructions on installing the USB enclosure, see User's Guide at [Dell.com/support](http://Dell.com/support).

1. Locate the Acronis activation key coupon.



2. Go to [Kingston.com/cloning/SNP](http://Kingston.com/cloning/SNP).  
3. Follow the instructions on the screen.

### Lost or misplaced Acronis activation key

1. Call **1-800-BUY-DELL**.
2. Provide proof of purchase details for verification.
3. A new activation key will be provided.
4. Go to [Kingston.com/cloning/SNP](http://Kingston.com/cloning/SNP).
5. Follow the instructions on the screen.

[Dell.com/support](http://Dell.com/support)  
[Dell.com/support/manuals](http://Dell.com/support/manuals)  
[Dell.com/regulatory\\_compliance](http://Dell.com/regulatory_compliance)